

SCHEDULE (GMT)

2024-12-14	2024-12-15	2024-12-16
Opening , 08:35 - 08:45		
A - Keynote CFECSStatistics2024 08:45 - 09:35	F CFECSStatistics2024 08:45 - 10:25	M CFECSStatistics2024 09:10 - 10:50
Coffee break 09:35 - 10:05	Coffee break 10:25 - 10:55	Coffee break 10:50 - 11:20
B CFECSStatistics2024 10:05 - 12:10	G CFECSStatistics2024 10:55 - 12:10	N - Keynote CFECSStatistics2024 11:20 - 12:10
Lunch break 12:10 - 13:40	Lunch break 12:10 - 13:40	Lunch break 12:10 - 13:40
C CFECSStatistics2024 13:40 - 15:20	H CFECSStatistics2024 13:40 - 15:20	O - Keynote CFECSStatistics2024 13:40 - 14:30
D - Keynote CFECSStatistics2024 15:30 - 16:20	Coffee break 15:20 - 15:50	P CFECSStatistics2024 14:40 - 16:20
Coffee break 16:20 - 16:50	I CFECSStatistics2024 15:50 - 17:30	Coffee break 16:20 - 16:50
E CFECSStatistics2024 16:50 - 18:55	J CFECSStatistics2024 17:40 - 18:55	Q CFECSStatistics2024 16:50 - 18:30
Welcome reception 19:00 - 20:30		Closing networking drink 18:40 - 19:40
	Christmas Conference Dinner 20:00 - 23:00	

TUTORIALS, MEETINGS AND CONFERENCE DETAILS (see maps)

TUTORIALS

Three independent tutorials will take place from the 11th to the 13th of December 2024, organized within the framework of the COST Action HiTEc. The first tutorial, “Regularization methods in statistics with an application to brain imaging studies”, will be coordinated by Prof. Jaroslaw Harezlak from Indiana University, USA. The second tutorial, “Bayesian nonparametrics methods”, will be coordinated by Prof. Michele Guindani, UCLA, USA. The third tutorial, “Robust modelling of volatility and other non-negative variables”, will be coordinated by Prof. Genaro Sucarrat, BI Norwegian Business School, Norway. Further details are available on the website. Only participants who have subscribed to the tutorials can attend, either in person or virtually through the conference website.

SPECIAL MEETINGS

The *Econometrics and Statistics (EcoSta) Editorial Board* and the *CSDA and Annals of Statistical Data Science Editorial Board* meetings will take place on Friday, 13th of December 2024. Details to attend will be sent to the associate editors attending the conference in due course.

CONFERENCE DETAILS

Access

- Attendees can choose to participate virtually or in person based on their selected registration option.
- The in-person venue is King’s College London, Strand campus (Strand, London WC2R 2LS, United Kingdom).
- Instructions to access the virtual part of the conference can be found on the webpage.
- Registration will be open on Friday afternoon, from 14:00 to 18:00, during the weekend from 7:45 to 18:00 and on Monday from 8:15 to 16:30 in the Arcade of the Bush House - Central Block (ground floor).

Scientific programme and social events

- The conference will be live-streamed, with no recording available. Virtual oral presentations and posters will take place through Zoom.
- **Scientific programme:** Sessions are accessible online from the interactive schedule. The conference programme time is set in GMT. Indications to access the in-person and virtual rooms can be found on the website. The in-person participants can use S-2.23 as quiet room and to participate in virtual sessions with their laptops and headphones.
- **Coffee breaks:** The coffee breaks will last 40 minutes each (beginning 10 minutes before the times indicated in the program). These will take place at the Great Hall of the King’s Building (ground floor) and the Arcade of the Bush House - Central Block (ground floor). Participants must bring their conference badge to attend.
- **Welcome reception:** The welcome reception for registered participants will take place at the King’s building, Great Hall (Ground floor) and the Chapters (Level 2), on Saturday the 14th of December 2024 from 19:00 to 20:30 (GMT). Participants must bring their conference badge to attend the reception. Information about the welcome reception booking is embedded in the QR code on the conference badge.
- **Christmas Conference Dinner:** The Christmas Conference Dinner will take place on Sunday the 15th of December 2024, at 20:00 at the Ambassadors Bloomsbury Hotel (12 Upper Woburn Pl, London WC1H 0HX). The conference dinner is optional, and registration is required. Participants must bring their conference badge to attend the conference dinner. Information about the purchased conference dinner ticket is embedded in the QR code on the conference badge.
- **Closing networking drink:** A closing networking drink will take place on Monday, the 16th of December 2024, at 18:40 at the pub “The Last Judgment” (95 Chancery Lane, London WC2A 1DT). Participants must bring their conference badge to attend and get their voucher for a drink at the entrance.

Presentation instructions

Virtual presentations will take place through Zoom. Speakers should have a stable internet connection, and ensure their video and audio function correctly. They will share their slides when the Chair requests, present their talk, and answer the questions after the presentation. In-person speakers must copy their presentations onto the conference room laptops and share them on Zoom. Laptops are equipped with a webcam and an omnidirectional desk microphone that captures sound around the desk. Detailed instructions for speakers are available on the website. As a general rule, each speaker is assigned 20 minutes for the talk and 3-4 minutes for discussion. Strict timing must be observed.

Posters

Posters will be displayed on Zoom. In-person participants can optionally join the poster session from the room designated in the programme with their devices. Presenters should enter the poster session 10 minutes before the session starts by following the instructions for accessing it, select the breakout room with their poster code (e.g. E0123), share their poster and remain with their camera, microphone, and audio on throughout the entire session. They should also keep their chat visible.

Session chairs

Session chairs will be responsible for introducing the session and speakers, and coordinating discussion time. A conference staff member, identified on Zoom as “Angel”, will assist online. In case of a missing or technical problem with a speaker, the Chair can move to the next speaker and return later if possible. Detailed instructions for session chairs in both virtual and hybrid sessions can be found on the website.

Test session

A test session is scheduled for Saturday the 7th of December 2024 from 14:00 to 14:30 (GMT). Participants will be able to virtually enter the Auditorium from the interactive programme to test presentations, video, micro and audio (e.g., through Slot A). Detailed instructions for test sessions are available on the website.

Maps of the venue and nearby area

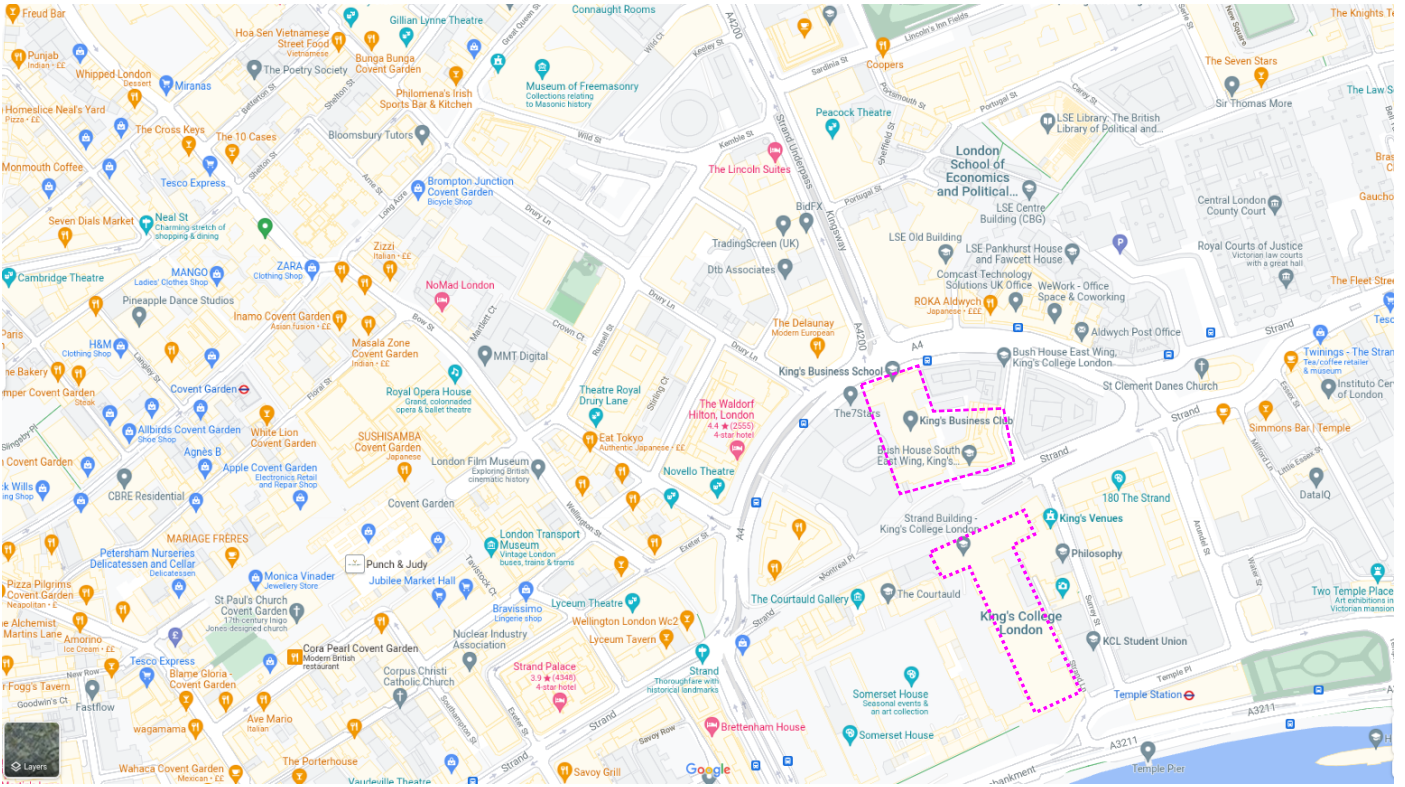

- A** King's Building
- B** Strand Building
- C** Maughan Library
- D** Quadrangle
- E** 152-158 Strand
- F** Virginia Woolf Building
- G** North Wing
- H** East Wing
- I** Philosophy Building
- J** Norfolk Building
- K** Chesham Building
- L** Macadam Building
- M** South East Block
- N** South West Block
- O** Drury Lane
- P** Modern Language Centre
- Q** Somerset House East Wing
- R** Bush House - Centre Block
- S** Bush House - SE Wing (Strand House)
- T** Bush House - Melbourne House
- U** Bush House - NE Wing (King House)

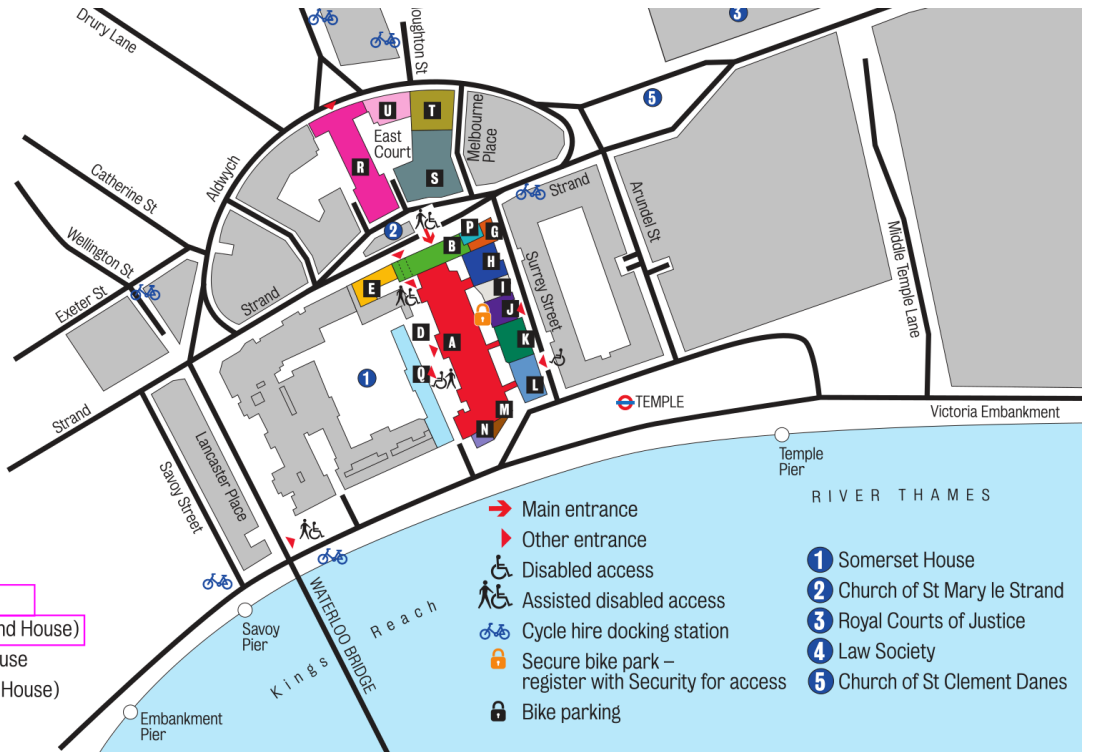

Map for the Christmas conference dinner

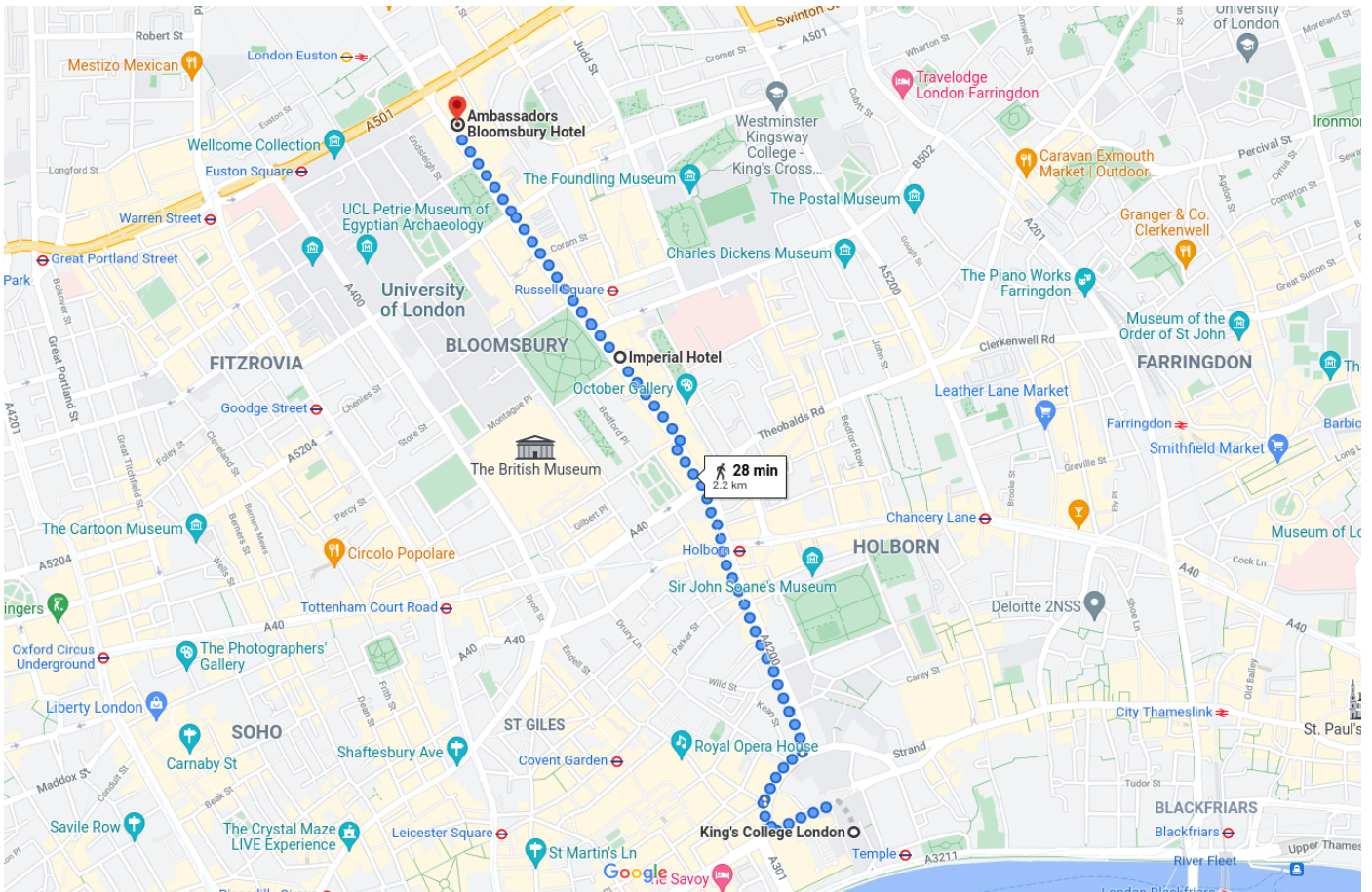

Map for the Closing drink

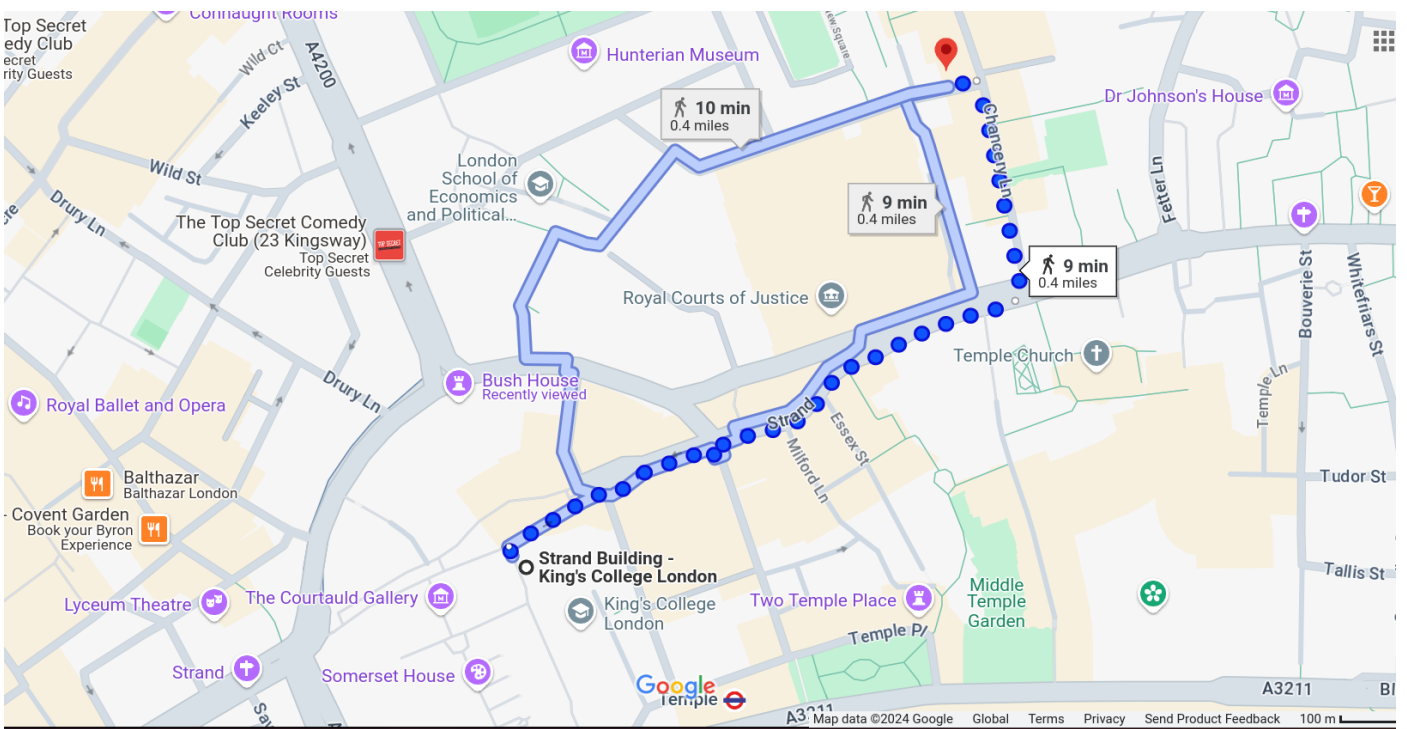

Floor maps

Bush House - Ground Floor

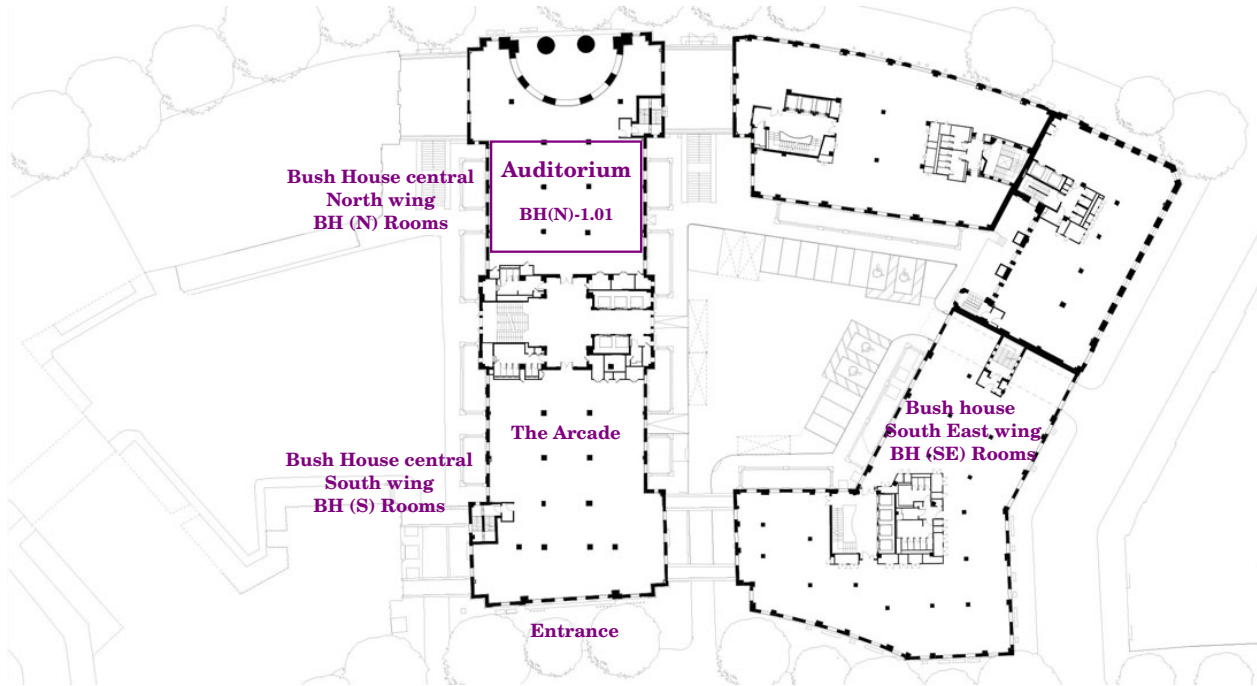

Bush House South Wing - First Floor

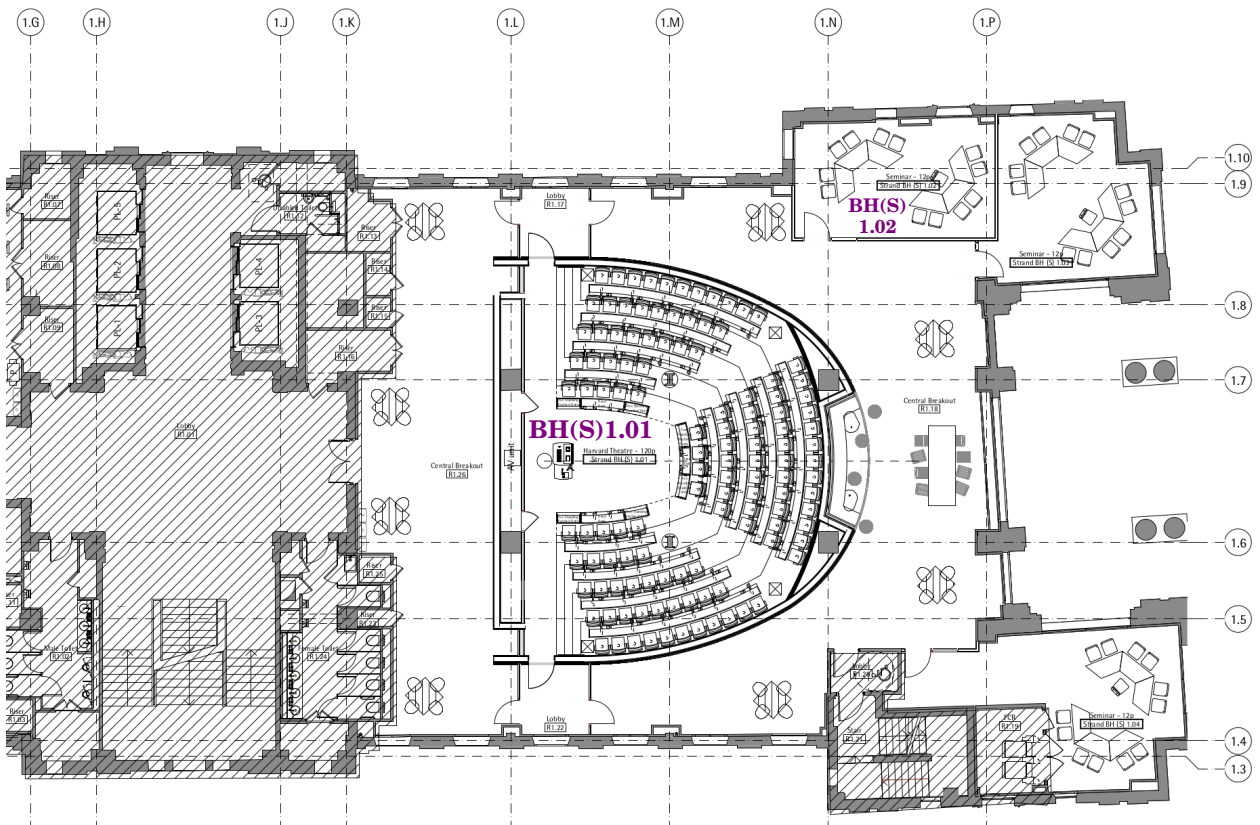

Bush House South Wing - Second Floor

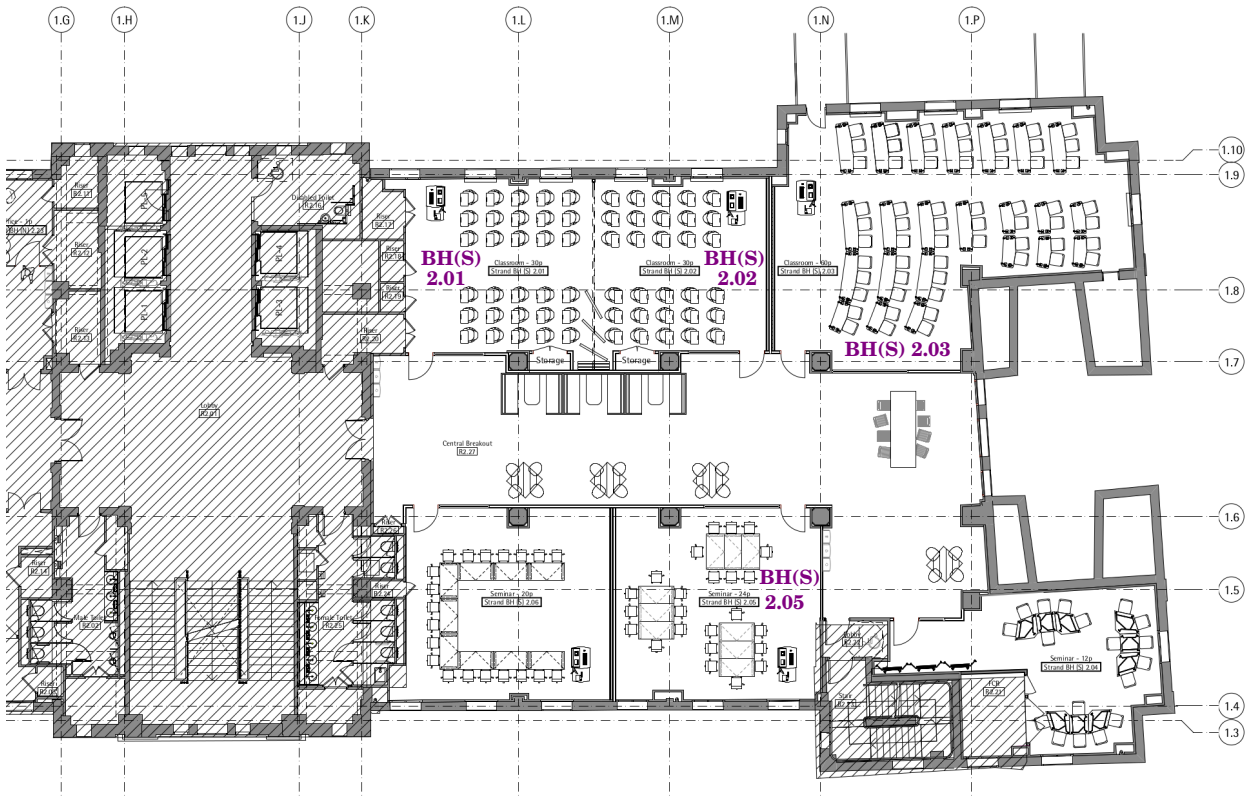

Bush House South East Wing - First Floor



Bush House South East Wing - Second Floor



Strand Campus

Strand Building – Basement 2

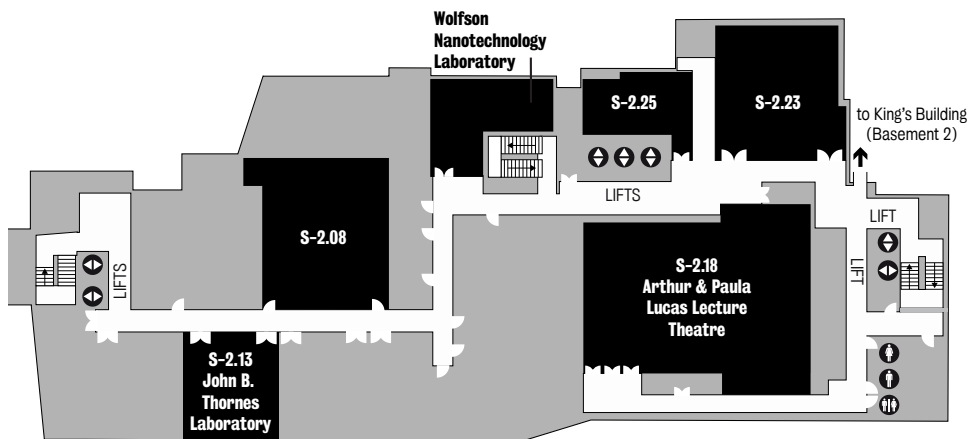

Strand Campus

Strand Building – Basement 1

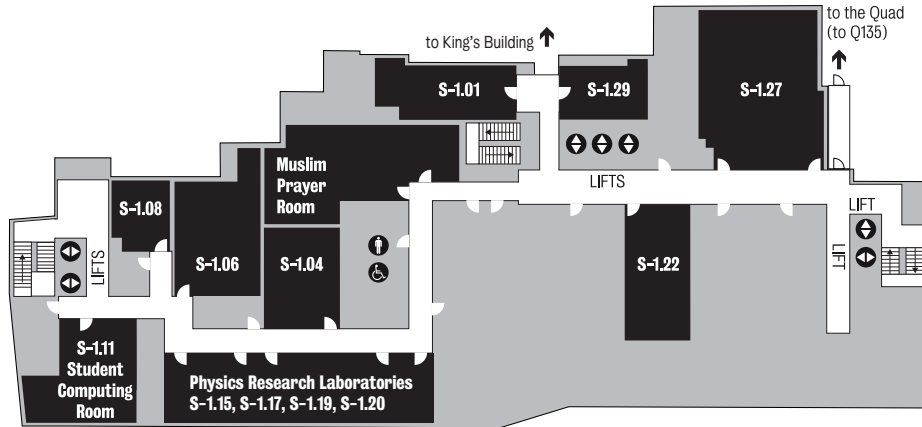

Strand Campus

Strand Building – Ground floor

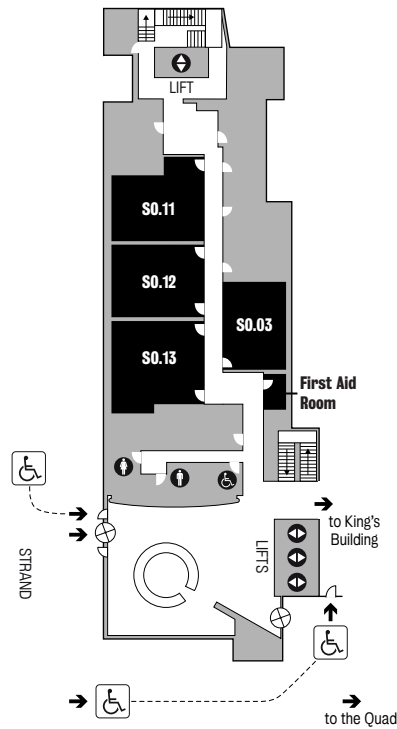

The non-stepped accessible route in to the building is to the rear of the main reception area. This route is via the black gated entrance and turn left. There is also a button-controlled self-opening door at the front of the main reception but this requires reception staff to activate it.

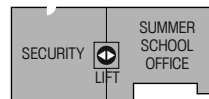

Strand Campus

King's Building - Level 0

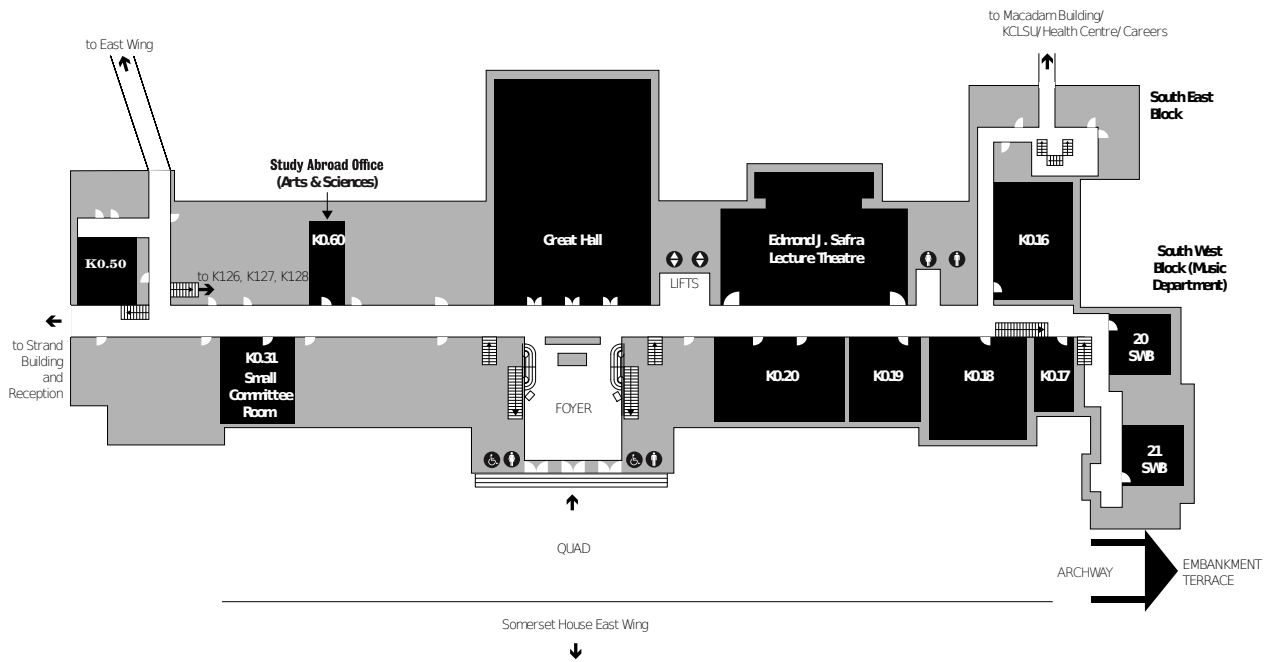

Strand Campus

King's Building - Level 2

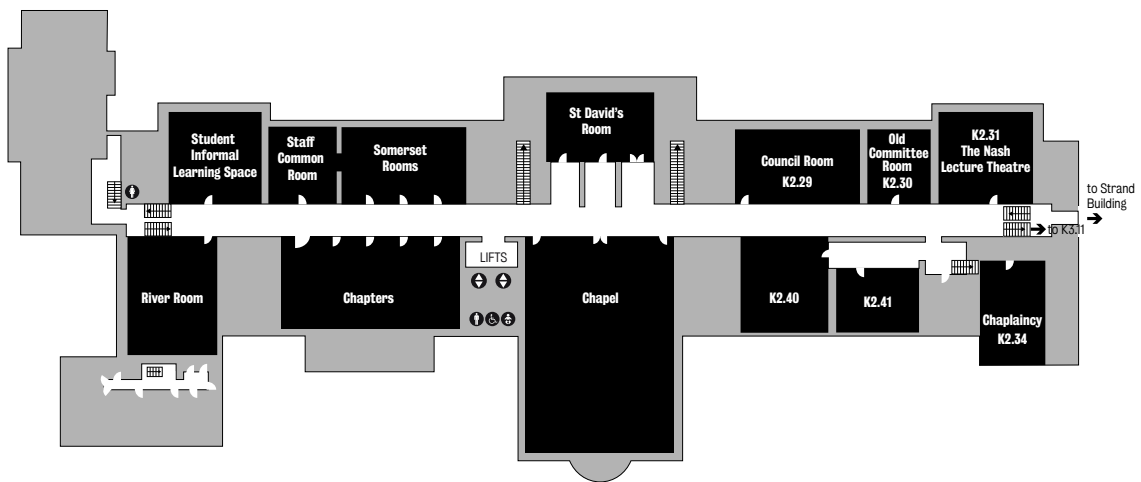

Keynote talk I	Room Auditorium	Saturday 14.12.2024	08:45 - 09:35
BAYESIAN MODELING IN NEUROIMAGING: BRAIN NETWORKS DYNAMICS			
Speaker: Michele Guindani, University of California Los Angeles, United States			
Keynote talk II	Room Auditorium	Saturday 14.12.2024	15:30 - 16:20
TOWARDS INTERPRETABLE AND TRUSTWORTHY NETWORK-ASSISTED PREDICTION			
Speaker: Liza Levina, University of Michigan, United States			
Keynote talk III	Room Auditorium	Monday 16.12.2024	11:20 - 12:10
REGRESSION MODELLING UNDER GENERAL HETEROGENEITY			
Speaker: George Kapetanios, Kings College London, United Kingdom			
Keynote talk IV	Room Auditorium	Monday 16.12.2024	13:40 - 14:30
STATISTICS FOR COMPLEX DATA OBJECTS - OF BRAIN STRUCTURES, CELL SHAPES AND INCOME SHARE DISTRIBUTIONS			
Speaker: Sonja Greven, Humboldt University of Berlin, Germany			

Parallel Session B – CFECMStatistics2024 Saturday 14.12.2024 10:05 - 12:10

- CI051 HIGH-DIMENSIONAL TIME SERIES (Room Auditorium)
- CO170 HiTEC: ADVANCES IN FINANCIAL ECONOMETRICS (Room S-1.01)
- CO005 STOCHASTIC PROCESSES: THEORY AND APPLICATIONS (Room S-1.04)
- CO350 STATISTICAL ANALYSIS OF NETWORKS AND APPLICATIONS (Room K0.16)
- CO279 COMPLEX ENVIRONMENTAL DATA AND MODELING (CoENV) (Room K0.19)
- CO376 FACTORIAL DESIGNS UNDER MODEL UNCERTAINTY (Room K0.50)
- CO126 NEW ADVANCES IN SMALL AREA ESTIMATION (Room K2.31 (Nash Lec. Theatre))
- CO036 HIGH DIMENSIONAL MULTIVARIATE MODELS WITH APPLICATIONS (Room K2.40)
- CO028 RECENT ADVANCES IN STRUCTURAL EQUATION MODELLING (Room K2.41)
- CO011 IMPROVING STATISTICAL IMAGE ANALYSIS (Room S0.11)
- CO321 SNAPSHOT ON CURRENT FUNCTIONAL DATA METHODOLOGIES (Room Safra Lec. Theatre)
- CO246 RECENT CONTRIBUTIONS IN APPLIED ECONOMETRICS (Room BH (S) 1.01 Lec. Theatre 1)
- CO069 ADVANCES IN HIGH/INFINITE-DIMENSIONAL INFERENCE (VIRTUAL) (Room BH (SE) 1.01)
- CO180 ADVANCES IN BAYESIAN MIXTURE MODELING APPLIED TO COMPLEX DATASETS (Room BH (SE) 1.02)
- CO017 WEATHERING THE CLIMATE STORM: FINANCIAL RESILIENCE (Room BH (SE) 1.05)
- CO159 ADVANCES IN BAYESIAN METHODS (Room BH (SE) 1.06)
- CO271 MODELING FINANCIAL TIME SERIES WITH CONOMETRICS AND MACHINE LEARNING (Room BH (S) 2.01)
- CO205 RECENT ADVANCES IN WELL-BEING AND POVERTY MEASUREMENT (Room BH (S) 2.02)
- CO196 ADVANCES IN BAYESIAN MACRO- AND FINANCIAL ECONOMETRICS (Room BH (S) 2.03)
- CO307 FORECASTING: THEORY AND PRACTICE (Room BH (SE) 2.05)
- CO247 INEQUALITY AND MACROECONOMIC DYNAMICS (Room BH (SE) 2.09)
- CO233 RECENT DEVELOPMENTS IN THE ECONOMETRICS OF COMMODITY MARKETS (Room BH (SE) 2.10)
- CO218 ADVANCES IN PANEL DATA AND CAUSAL INFERENCE (Room BH (SE) 2.12)
- CC459 NONPARAMETRIC STATISTICS (Room S-2.25)
- CC492 CLUSTERING (Room S-1.06)
- CC425 MULTIVARIATE METHODS (Room S-1.27)
- CC446 APPLIED STATISTICS (Room K0.18)
- CC478 ROBUST STATISTICS (Room K0.20)
- CC462 HIGH-DIMENSIONAL STATISTICS AND ECONOMETRICS (Room S0.03)
- CC439 EXTREME VALUES (Room S0.12)
- CC454 BIostatISTICS (Room S0.13)
- CC443 ASSET PRICING (Room BH (S) 2.05)
- CC501 ADVANCES IN ECONOMETRICS AND FINANCIAL MODELLING (Room BH (SE) 2.01)

Parallel Session C – CFECMStatistics2024 Saturday 14.12.2024 13:40 - 15:20

- CO261 COPULAS: METHODOLOGY AND APPLICATIONS (Room S-2.25)
- CO328 HiTEC: THEORY AND APPLICATIONS IN FUNCTIONAL STATISTICS (Room S-1.01)
- CO140 BRANCHING AND RELATED PROCESSES I (Room S-1.04)
- CO239 RECENT ADVANCES IN HIGH-DIMENSIONAL STATISTICAL LEARNING (Room S-1.06)
- CO317 SELECTED TOPICS IN STATISTICAL MACHINE LEARNING (Room S-1.27)
- CO104 NON-GAUSSIAN AND NONCAUSAL TIME SERIES (Room Auditorium)
- CO131 NOVEL INFERENCE AND MODELING ON NETWORK DATA AND APPLICATIONS (Room K0.16)
- CO083 STATISTICAL METHODS IN WEATHER FORECASTING I (Room K0.18)
- CO410 STATISTICAL AND COMPUTATIONAL METHODS FOR LONGITUDINAL AND SURVIVAL DATA (Room K0.19)
- CO117 DISTANCE BASED METHODS IN MODEL SPECIFICATION TESTING AND SELECTION (Room K0.20)
- CO270 DESIGN AND ANALYSIS OF COMPLEX EXPERIMENTS (VIRTUAL) (Room K0.50)
- CO080 ADVANCES IN CAUSAL INFERENCE (Room K2.31 (Nash Lec. Theatre))
- CO228 HIGH-DIMENSIONAL TIME SERIES AND DATA INTEGRATION (Room K2.40)
- CO396 SURVIVAL ANALYSIS: TRUNCATED DATA (Room K2.41)
- CO156 NEW ADVANCES ON COMPUTATIONALLY EFFICIENT STATISTICAL INFERENCE (VIRTUAL) (Room S0.03)
- CO013 ADVANCES IN COMPUTATIONAL NEUROSCIENCE (Room S0.11)
- CO110 MACHINE LEARNING METHODS IN EXTREMES (Room S0.12)
- CO125 RECENT ADVANCES IN BIostatISTICS (Room S0.13)
- CO178 METHODS FOR ANALYZING STRUCTURED DATA (Room Safra Lec. Theatre)
- CO026 TOPICS IN TIME SERIES ECONOMETRICS (Room BH (S) 1.01 Lec. Theatre 1)
- CO064 ADVANCES IN HIGH-DIMENSIONAL BAYESIAN INFERENCE (Room BH (SE) 1.01)
- CO121 MODERN CHALLENGES IN BAYESIAN NONPARAMETRIC INFERENCE (Room BH (SE) 1.02)
- CO168 RECENT DEVELOPMENTS IN FINANCIAL MODELLING AND FORECASTING (Room BH (SE) 1.05)
- CO008 THEORY AND IMPLEMENTATION OF STATISTICS FOR STOCHASTIC PROCESSES (Room BH (SE) 1.06)
- CO372 FINANCIAL ECONOMETRICS AND MACHINE LEARNING (Room BH (S) 2.01)
- CO385 HETEROGENEITY IN PANEL DATA MODELS (Room BH (S) 2.02)
- CO175 QUANTITATIVE CLIMATE ANALYSIS (Room BH (S) 2.03)
- CO010 TOPICS IN FINITE SAMPLE ECONOMETRICS (Room BH (S) 2.05)
- CO409 ADVANCES IN CLUSTERING AND ITS APPLICATION AREAS (Room BH (SE) 2.01)
- CO250 STATISTICAL METHODS FOR NETWORK PSYCHOMETRICS (Room BH (SE) 2.05)
- CO114 STATISTICAL MODELS AND METHODS FOR EDUCATION I (Room BH (SE) 2.10)
- CO302 SPATIOTEMPORAL INFECTIOUS DISEASE MODELING AND SURVEILLANCE (Room BH (SE) 2.12)
- CC499 ECONOMETRIC MODELS IN ENERGY AND FINANCE (Room BH (SE) 2.09)

Parallel Session E – CFECMStatistics2024 Saturday 14.12.2024 16:50 - 18:55

- CO341 DIRECTIONAL STATISTICS (Room S-2.25)
- CO041 HiTEC: CLUSTERING OF COMPLEX DATA STRUCTURES (Room S-1.01)
- CO141 BRANCHING AND RELATED PROCESSES II (Room S-1.04)
- CO165 OVER-PARAMETRIZATION AND OVERFITTING IN MACHINE LEARNING (Room S-1.06)
- CO101 RESAMPLING METHODS IN MODERN SETTINGS (Room S-1.27)
- CO301 NEW DEVELOPMENTS IN FINANCIAL ECONOMETRICS (Room Auditorium)

CO379 ADVANCES IN NETWORKS AND CAUSAL INFERENCE (Room K0.16)
 CO358 STATISTICAL METHODS IN WEATHER FORECASTING II (Room K0.18)
 CO194 STATISTICAL CHALLENGES IN INTERDISCIPLINARY BIOMEDICAL RESEARCH (Room K0.19)
 CO093 MODEL ASSESSMENT (Room K0.20)
 CO148 EXPERIMENTAL DESIGN: SCREENING EXPERIMENTS (Room K0.50)
 CO257 STATISTICS AND SPORT (Room K2.31 (Nash Lec. Theatre))
 CO375 RECENT APPROACHES TO ENVIRONMENTAL AND SPATIO-TEMPORAL STATISTICS (Room K2.40)
 CO408 MODERN STATISTICAL INFERENCE METHODS FOR COMPLEX DATA ANALYSIS (Room K2.41)
 CO089 ADVANCES IN DATA INTEGRATION FOR LARGE-SCALE OBSERVATIONAL STUDIES (Room S0.11)
 CO115 COPULA AND EXTREME DEPENDENCE (Room S0.12)
 CO325 BAYESIAN AND COMPUTATIONAL METHODS FOR BETTER HEALTHCARE DECISIONS (Room S0.13)
 CO391 ADVANCES IN FUNCTIONAL AND SPATIAL DATA ANALYSIS (Room Safra Lec. Theatre)
 CO349 CLIMATE ECONOMETRICS (Room BH (S) 1.01 Lec. Theatre 1)
 CO142 BAYESIAN STATISTICS (Room BH (SE) 1.01)
 CO046 TOPICS IN BAYESIAN MODELING AND COMPUTATION (Room BH (SE) 1.02)
 CO189 FINANCIAL MODELING: REGIME SWITCHING AND STATISTICAL LEARNING (Room BH (SE) 1.05)
 CO068 RECENT DEVELOPMENTS IN THEORETICAL STATISTICS (Room BH (SE) 1.06)
 CO172 FOUNDATIONS OF MACHINE LEARNING FOR ECONOMICS AND FINANCE (Room BH (S) 2.01)
 CO234 ADVANCED STATISTICAL TECHNIQUES: FROM RISK TO AI AND BEYOND (Room BH (S) 2.02)
 CO311 MODELING AND MEASURING MULTIVARIATE VOLATILITY AND RISK (Room BH (S) 2.03)
 CO259 EMPIRICAL MACRO (Room BH (SE) 2.09)
 CO161 STATISTICAL MODELS AND METHODS FOR EDUCATION II (Room BH (SE) 2.10)
 CO304 STATISTICS IN GEOSCIENCES (Room BH (SE) 2.12)
 CC504 STATISTICAL METHODS AND APPLICATIONS I (Room S0.03)
 CC490 MCMC METHODS AND BAYESIAN COMPUTATION (Room BH (S) 2.05)
 CC427 TIME SERIES (Room BH (SE) 2.01)
 CC482 RISK ANALYSIS (Room BH (SE) 2.05)

Parallel Session F – CFECMStatistics2024

Sunday 15.12.2024

08:45 - 10:25

CI052 RECENT ADVANCES IN CLUSTERING (Room Auditorium)
 CO381 RECENT ADVANCES IN THEORY AND METHODS OF DEPENDENT DATA (Room S-2.25)
 CO103 HiTEC: RECENT PROGRESS IN HIGH-DIMENSIONAL TIME SERIES (Room S-1.01)
 CO058 RECENT DEVELOPMENTS IN STATISTICAL MODELING FOR STOCHASTIC PROCESSES (Room S-1.04)
 CO097 CONTEMPORARY DIRECTIONAL STATISTICS (Room S-1.06)
 CO314 RECENT ADVANCES OF STATISTICAL INFERENCE (Room S-1.27)
 CO095 NEW DEVELOPMENTS IN STATISTICAL NETWORK ANALYSIS (Room K0.16)
 CO222 STATISTICAL METHODS FOR ENVIRONMENTAL SCIENCES (Room K0.18)
 CO323 BAYESIAN METHODS FOR EXTREME VALUES (Room K0.19)
 CO294 DISTANCE AND DEPTH BASED METHODS FOR DATA SCIENCE (Room K0.20)
 CO087 DESIGN OF EXPERIMENTS FOR COMPLEX DATA (Room K0.50)
 CO237 HIGH-DIMENSIONAL STATISTICS FOR GENOMICS AND BIOMEDICINE (Room K2.31 (Nash Lec. Theatre))
 CO352 HIGH-DIMENSIONAL STATISTICS WITH NUISANCE PARAMETERS (Room K2.40)
 CO176 EXTREME RISKS ANALYSIS AND REAL LIFE APPLICATIONS (Room K2.41)
 CO340 PROBABILISTIC PREDICTION OF COMPLEX DATA (Room S0.03)
 CO045 SPATIAL INFERENCE FOR fMRI ANALYSIS (Room S0.11)
 CO229 EXTREMES AND LEVY PROCESSES (Room S0.12)
 CO007 RECENT TOPICS IN BIOSTATISTICS (Room S0.13)
 CO134 ADVANCES IN FUNCTIONAL AND OBJECT ORIENTED DATA ANALYSIS (Room Safra Lec. Theatre)
 CO122 MODELLING NON-STATIONARITY AND STRUCTURAL CHANGE (Room BH (S) 1.01 Lec. Theatre 1)
 CO231 PREDICTION AND CLUSTERING UNDER BAYESIAN MIXTURE MODELS (Room BH (SE) 1.02)
 CO127 TIME SERIES MODELING IN FINANCE AND INSURANCE (Room BH (SE) 1.05)
 CO016 HiTEC: ADVANCES IN FINANCE AND STATISTICS (Room BH (SE) 1.06)
 CO077 MODELLING RISK AND UNCERTAINTY (Room BH (S) 2.01)
 CO281 ECONOMETRICS OF GROWTH CONVERGENCE AND ENERGY MARKETS (Room BH (S) 2.02)
 CO079 MODELS WITH LARGE DIMENSIONAL AND FUNCTIONAL VARIABLES (Room BH (S) 2.03)
 CO071 MARKOV SWITCHING PROCESSES AND APPLICATIONS (Room BH (S) 2.05)
 CO389 PERSPECTIVE IN EXPLORING DEPENDENCY (Room BH (SE) 2.01)
 CO306 MACROECONOMIC CONSEQUENCES OF CLIMATE CHANGE (Room BH (SE) 2.05)
 CO004 MACRO-FINANCE APPLICATIONS OF QUANTILE VAR MODELS (Room BH (SE) 2.09)
 CO356 TOPICS IN ECONOMIC POLICY AND INTERNATIONAL FINANCE (Room BH (SE) 2.12)
 CC442 BAYESIAN ECONOMETRICS (Room BH (SE) 1.01)
 CC496 FINANCIAL ECONOMETRICS I (Room BH (SE) 2.10)

Parallel Session G – CFECMStatistics2024

Sunday 15.12.2024

10:55 - 12:10

CO085 HiTEC: TOPICS IN FINANCIAL ECONOMETRICS AND REGIME SWITCHING MODELS (Room S-1.01)
 CO339 APPLICATIONS OF POINT PROCESS AND RELATED MODELS FOR COUNTS (VIRTUAL) (Room S-1.04)
 CO401 MACHINE LEARNING AND GLOBAL HEALTH (Room S-1.27)
 CO367 NOVEL STATISTICAL TOOLS FOR BIOMEDICAL RESEARCH (Room K0.18)
 CO253 ADVANCE IN MODERN DATA ANALYSIS (Room K0.19)
 CO251 RECENT ADVANCES IN SUFFICIENT DIMENSION REDUCTION (Room K0.20)
 CO209 ADVANCES IN OPTIMAL EXPERIMENTAL DESIGN (Room K0.50)
 CO204 INFERENCE FOR FEDERATED LEARNING AND SYNTHETIC CONTROL (Room K2.31 (Nash Lec. Theatre))
 CO002 RECENT ADVANCES IN STATISTICAL METHODS FOR PRACTICAL APPLICATIONS (Room K2.40)
 CO346 MATHEMATICS OF DEEP-LEARNING FOR SOLVING DIFFERENTIAL EQUATIONS (Room S0.03)
 CO300 STATISTICAL METHODS FOR HIGH-DIMENSIONAL NEUROIMAGING AND TIME SERIES DATA (Room S0.11)
 CO312 ANALYSIS OF EXTREME VALUES: THEORY AND APPLICATIONS (Room S0.12)
 CO105 UNCERTAINTY QUANTIFICATION (Room S0.13)
 CO014 TIME SERIES ECONOMETRICS (Room BH (S) 1.01 Lec. Theatre 1)
 CO202 BAYESIAN ECONOMETRICS IN ECONOMICS AND FINANCE (Room BH (SE) 1.01)
 CO047 BAYESIAN COMPUTATION (Room BH (SE) 1.02)
 CO185 ECONOMETRICS AND FORECASTING FOR ECONOMIC AND FINANCIAL MARKETS (Room BH (SE) 1.05)
 CO106 MODELLING INVESTMENT DECISION MAKING AND ASSET PRICING (Room BH (SE) 1.06)
 CO336 ADVANCES IN FINANCIAL ECONOMETRICS AND RISK ANALYTICS (Room BH (S) 2.01)
 CO322 STATISTICS FOR COMPLEX-VALUED TIME SERIES AND INTEGER-VALUED TIME SERIES (Room BH (S) 2.02)
 CO158 FINANCIAL ECONOMETRICS: BUBBLES AND FORECASTING (Room BH (S) 2.03)
 CO275 J-ISBA SESSION ON RECENT ADVANCES IN BAYESIAN STATISTICS (Room BH (S) 2.05)
 CO133 Y-SIS - ADVANCES IN STATISTICAL LEARNING AND CLUSTERING (Room BH (SE) 2.01)
 CO284 MODELLING AND ANALYSING THE TRANSITION TO GREEN ENERGY (Room BH (SE) 2.05)
 CO308 ADVANCES IN MACROECONOMETRICS (Room BH (SE) 2.09)
 CO182 ANALYSIS OF COMPLEX MULTIVARIATE DATA (Room BH (SE) 2.10)
 CC470 METHODOLOGICAL STATISTICS (Room S-2.25)
 CC497 BAYESIAN CAUSAL INFERENCE (Room S-1.06)
 CC502 COMPUTATIONAL AND METHODOLOGICAL STATISTICS (Room K0.16)

CC413 SURVIVAL ANALYSIS (Room K2.41)
CC431 FUNCTIONAL DATA ANALYSIS (Room Safra Lec. Theatre)
CC493 RISK MANAGEMENT AND PORTFOLIO OPTIMIZATION (Room BH (SE) 2.12)
CP001 POSTER SESSION (Room Auditorium)

Parallel Session H – CFECMStatistics2024

Sunday 15.12.2024

13:40 - 15:20

CI054 ADVANCES IN MODELLING FINANCIAL AND ECONOMIC UNCERTAINTY (Room Auditorium)
CO368 INDUSTRIAL STATISTICS (VIRTUAL) (Room S-2.23)
CO072 SPORTS ANALYTICS (Room S-2.25)
CO063 HiTEC: TOPICS ON HIGH DIMENSIONAL STATISTICS (Room S-1.01)
CO149 COMPUTATIONAL ASYMPTOTIC STATISTICS FOR STOCHASTIC PROCESSES (Room S-1.04)
CO183 NEW CHALLENGES IN MODERN STATISTICS AND DATA ANALYSIS (VIRTUAL) (Room S-1.06)
CO221 ALL MODELS ARE WRONG BUT MANY ARE USEFUL (Room S-1.27)
CO135 RECENT ADVANCES IN NETWORKS AND HIGH DIMENSIONAL DATA (Room K0.16)
CO096 INNOVATIVE STATISTICAL APPROACHES FOR CLIMATE CHANGE STUDIES (Room K0.18)
CO091 RECENT DEVELOPMENTS ON DATA DEPTH AND FUNCTIONAL DATA ANALYSIS (Room K0.20)
CO157 RECENT ADVANCES IN DESIGN AND ANALYSIS OF EXPERIMENTS (Room K0.50)
CO355 STATISTICAL LEARNING IN CAUSAL INFERENCE (Room K2.31 (Nash Lec. Theatre))
CO331 COMPETING RISKS AND DEPENDENT SURVIVAL MODELS WITH PARAMETRIC ELEMENTS (Room K2.41)
CO022 STATISTICS IN NEUROSCIENCE I (Room S0.11)
CO188 TRANSFORMATIVE APPROACHES IN MACHINE LEARNING (Room S0.12)
CO264 NEW ADVANCES IN BIostatISTICS (Room S0.13)
CO348 FUNCTIONAL DATA ANALYSIS AND STOCHASTIC PROCESSES (Room Safra Lec. Theatre)
CO298 FORECASTING AND PANEL ANALYSIS (Room BH (S) 1.01 Lec. Theatre 1)
CO398 RECENT ADVANCES IN BAYESIAN METHODS (Room BH (SE) 1.01)
CO098 BAYESIAN SEMI- AND NON-PARAMETRIC METHODS III (Room BH (SE) 1.02)
CO387 NOWCASTING AND FORECASTING MACROECONOMIC AND FINANCIAL RISK (Room BH (SE) 1.05)
CO049 CLIMATE AND SUSTAINABLE FINANCE (Room BH (SE) 1.06)
CO184 ADVANCES IN TIME SERIES AND PANEL DATA ECONOMETRICS (Room BH (S) 2.01)
CO390 NEW DIRECTIONS IN DETECTING CHANGES AND CLUSTERS (Room BH (S) 2.02)
CO326 NEW DEVELOPMENTS IN FINANCIAL TIME SERIES (Room BH (S) 2.03)
CO191 PANEL MODELS (Room BH (S) 2.05)
CO213 MULTIVARIATE DEPENDENCE STRUCTURES (Room BH (SE) 2.01)
CO330 SUPERVISED, DEEP, AND REINFORCEMENT LEARNING IN ECONOMIC AND FINANCE (Room BH (SE) 2.05)
CO219 CWS SESSION: STATISTICS AND DATA SCIENCE FROM WOMEN AROUND THE GLOBE (Room BH (SE) 2.10)
CO024 RECENT ADVANCES IN SPATIAL AND SPATIO-TEMPORAL DATA MODELING (Room BH (SE) 2.12)
CC510 STATISTICAL METHODS AND APPLICATIONS II (Room K0.19)
CC438 MACHINE LEARNING IN APPLICATIONS (Room K2.40)
CC416 STATISTICAL MODELLING (Room S0.03)
CC458 MACROECONOMETRICS (Room BH (SE) 2.09)

Parallel Session I – CFECMStatistics2024

Sunday 15.12.2024

15:50 - 17:30

CI053 CHALLENGES IN PREDICTION IN TIMES OF CLIMATE RISKS AND GLOBAL CONFLICTS (Room Auditorium)
CO015 ANOMALIES IN ASSET PRICING (VIRTUAL) (Room S-2.23)
CO332 INTEGRATIVE ANALYSIS OF MULTI-SOURCE AND MULTI-WAY DATA (Room S-2.25)
CO162 HiTEC: TOPICS IN FINANCIAL ECONOMETRICS (Room S-1.01)
CO254 ESTIMATION FOR JUMP PROCESS (Room S-1.04)
CO171 INFERENCE OF COMPLEX STOCHASTIC DYNAMIC MODELS (Room S-1.06)
CO273 ADVANCES IN ANALYZING HIGH DIMENSIONAL DATA (Room S-1.27)
CO060 ADVANCES IN LONGITUDINAL STUDIES (Room K0.16)
CO288 ADVANCES IN MINIMAX OPTIMALITY (Room K0.18)
CO207 LATEST TRENDS IN CLUSTERING AND CLASSIFICATION OF COMPLEX DATA I (Room K0.19)
CO130 RECENT ADVANCES IN QUANTILE AND M-QUANTILE REGRESSION (Room K0.20)
CO249 SUBSAMPLING AND NON-LINEAR PROBLEMS: NEW PROPOSALS IN OPTIMAL DESIGN (Room K0.50)
CO285 EXPLORING NEW FRONTIERS IN CAUSAL MEDIATION ANALYSIS (Room K2.31 (Nash Lec. Theatre))
CO119 FRONTIERS IN STATISTICAL NETWORK ANALYSIS (Room K2.40)
CO319 SURVIVAL ANALYSIS: CENSORING AND COMPETING RISKS (Room K2.41)
CO266 RECENT DEVELOPMENTS IN BIostatISTICS AND BIOINFORMATICS (Room S0.03)
CO023 STATISTICS IN NEUROSCIENCE II (Room S0.11)
CO256 EXTREME VALUE THEORY FOR ENVIRONMENTAL APPLICATIONS (Room S0.12)
CO152 RECENT ADVANCES IN STATISTICS (Room S0.13)
CO059 STATISTICAL METHODS FOR FUNCTIONAL AND HIGH-DIMENSIONAL DATA (Room Safra Lec. Theatre)
CO070 ADVANCES IN MULTIVARIATE TIME SERIES ANALYSIS (Room BH (S) 1.01 Lec. Theatre 1)
CO369 BAYESIAN HIGH-DIMENSIONAL REGRESSION AND MODEL SELECTION (Room BH (SE) 1.01)
CO107 BAYESIAN SEMI- AND NON-PARAMETRIC METHODS II (Room BH (SE) 1.02)
CO296 CHANGE-POINT DETECTION FOR HIGH-DIMENSIONAL OR NON-EUCLIDEAN DATA (Room BH (SE) 1.05)
CO380 MODERN SEASONALITY AND RISK ANALYSIS (Room BH (SE) 1.06)
CO347 ECONOMETRICS APPLIED TO FINANCE AND INSURANCE (Room BH (S) 2.01)
CO151 ADVANCES IN STATISTICAL MODELLING FOR ECONOMICS AND FINANCE (Room BH (S) 2.02)
CO327 TIME SERIES ECONOMETRICS (Room BH (S) 2.03)
CO217 ECONOMETRICS OF ART MARKETS (Room BH (S) 2.05)
CO012 HIGH-DIMENSIONAL DATA (Room BH (SE) 2.01)
CO043 APPLIED MACRO-FINANCE I (Room BH (SE) 2.09)
CO025 SPATIAL STATISTICS: COMPUTER EMULATION, NEUROSCIENCE & ECOLOGY (Room BH (SE) 2.12)
CC507 COMPUTATIONAL AND FINANCIAL ECONOMETRICS (Room BH (SE) 2.05)
CC474 MACHINE LEARNING FOR ECONOMICS AND FINANCE I (Room BH (SE) 2.10)

Parallel Session J – CFECMStatistics2024

Sunday 15.12.2024

17:40 - 18:55

CO138 TRUSTWORTHY AI (VIRTUAL) (Room S-2.23)
CO382 RECENT APPROACHES IN SPECIES DISTRIBUTION MODELLING (Room S-2.25)
CO351 HiTEC: MODEL INSTABILITIES AND DATA DEPENDENCY (Room S-1.01)
CO508 ADVANCES IN DATA DEPTH (Room S-1.04)
CO337 INTERPRETABLE MACHINE LEARNING AND HIGH-DIMENSIONAL STATISTICS (VIRTUAL) (Room S-1.06)
CO262 STUDY DESIGN AND CAUSAL INFERENCE ISSUES IN COMPLEX BIOMEDICAL STUDIES (Room S-1.27)
CO032 DYNAMIC ECONOMETRICS (Room Auditorium)
CO286 NETWORK SCIENCE IN PUBLIC HEALTH (Room K0.16)
CO244 ENVIRONMENTAL DATA INTEGRATION, ESTIMATION, AND MAPPING (Room K0.18)
CO018 LATEST TRENDS IN CLUSTERING AND CLASSIFICATION OF COMPLEX DATA II (Room K0.19)
CO397 ADVANCES IN ROBUST PRIOR ELICITATION (Room K0.20)
CO033 COMPUTATIONAL METHODS FOR DESIGN OF EXPERIMENTS (Room K0.50)
CO195 MACHINE LEARNING-BASED FAIRNESS AND CAUSAL ESTIMATION (Room K2.31 (Nash Lec. Theatre))
CO102 MACHINE LEARNING METHODS AND THEIR APPLICATIONS IN BIOMEDICAL DATA ANALYSIS (Room K2.40)
CO081 ANALYZING HIGH-DIMENSIONAL DATA WITH NETWORK STRUCTURE (Room K2.41)
CO236 RECENT ADVANCES IN MACHINE LEARNING IN ECONOMETRICS (Room S0.03)

CO113 NEW DEVELOPMENTS IN NONPARAMETRIC STATISTICS AND NETWORK ANALYSIS (Room S0.12)
 CO035 MODELING STRATEGIES FOR BIOMEDICAL DATA (Room S0.13)
 CO062 ADVANCED TOPICS IN FUNCTIONAL AND OBJECT DATA ANALYSIS (VIRTUAL) (Room Safra Lec. Theatre)
 CO198 NONLINEAR AND NON-GAUSSIAN TIME SERIES (Room BH (S) 1.01 Lec. Theatre 1)
 CO038 BAYESIAN METHODS FOR RECORD LINKAGE AND SMALL AREA ESTIMATION (Room BH (SE) 1.01)
 CO109 BAYESIAN SEMI- AND NON-PARAMETRIC METHODS I (Room BH (SE) 1.02)
 CO211 MACHINE LEARNING AND BAYESIAN METHODS IN FINANCE (Room BH (SE) 1.05)
 CO366 RECENT ADVANCES ON NONPARAMETRIC PANEL DATA ANALYSIS (Room BH (SE) 1.06)
 CO145 TOPICS IN FINANCIAL ECONOMETRICS (Room BH (S) 2.03)
 CO210 STOCHASTIC DOMINANCE AND APPLICATIONS IN FINANCE (Room BH (S) 2.05)
 CO006 PROJECTION PURSUIT (Room BH (SE) 2.01)
 CO118 NEW CHALLENGES FOR STATISTICAL PROCESS CONTROL (Room BH (SE) 2.05)
 CO009 APPLIED MACRO-FINANCE II (Room BH (SE) 2.09)
 CO124 RECENT ADVANCEMENTS IN MODERN MULTIVARIATE PROBLEMS (Room BH (SE) 2.10)
 CO090 STATISTICAL METHODS FOR ANALYZING BIG AND COMPLEX DATA (VIRTUAL) (Room BH (SE) 2.12)
 CC424 COMPUTATIONAL STATISTICS (Room S0.11)
 CC471 FINANCIAL AND ECONOMETRIC MODELLING (Room BH (S) 2.01)
 CC434 PORTFOLIO MANAGEMENT (Room BH (S) 2.02)

Parallel Session M – CFECMStatistics2024

Monday 16.12.2024

09:10 - 10:50

CI050 BAYESIAN METHODS AND APPLICATIONS (Room Auditorium)
 CO282 METHODS AND MODELS FOR ENVIRONMENTAL AND ECOLOGICAL DATA I (Room S-2.25)
 CO193 BIostatISTICS AND MACHINE LEARNING: BENCHMARKING, EVALUATION AND BEYOND (Room S-1.06)
 CO225 STATISTICAL AND MACHINE LEARNING IN ENGINEERING (Room S-1.27)
 CO086 IMPACTFUL SPATIO-TEMPORAL STATISTICAL APPLICATIONS (Room K0.18)
 CO084 NEW APPROACHES AND APPLICATIONS OF SPATIAL STATISTICS (Room K0.19)
 CO383 DATA DEPTH FOR COMPLEX DATA TYPES AND APPLICATIONS (Room K0.20)
 CO203 DESIGN OF EXPERIMENTS AND APPLICATIONS (Room K0.50)
 CO260 ADVANCES IN CAUSAL INFERENCE (Room K2.31 (Nash Lec. Theatre))
 CO136 STATISTICAL SEQUENTIAL METHODS FOR DECISION-MAKING PROBLEMS (Room K2.40)
 CO173 SURVIVAL AND LONGITUDINAL DATA ANALYSIS (Room K2.41)
 CO154 RECENT DEVELOPMENT OF STATISTICAL METHODS FOR HANDLING COMPLEX DATA (Room S0.11)
 CO066 RECENT DEVELOPMENTS IN CLUSTERING FOR COMPLEX DATA STRUCTURE (Room S0.12)
 CO129 RECENT ADVANCES IN STATISTICAL MODELING FOR MEDICAL AND SOCIAL DATA (Room S0.13)
 CO153 RECENT ADVANCES IN FUNCTIONAL DATA ANALYSIS (Room Safra Lec. Theatre)
 CO305 INFERENCE FOR DEPENDENT DATA (Room BH (S) 1.01 Lec. Theatre 1)
 CO393 BAYESIAN APPLIED ECONOMETRICS (Room BH (SE) 1.01)
 CO139 RECENT ADVANCES IN SYMBOLIC DATA ANALYSIS (Room BH (SE) 1.02)
 CO489 COMPLEX STATISTICAL METHODS FOR ENERGY POVERTY RELATED ISSUES (Room BH (SE) 1.06)
 CO123 ADVANCES IN QUANTITATIVE RISK MANAGEMENT (Room BH (S) 2.01)
 CO404 EMPIRICAL AND COMPUTATIONAL METHODS FOR FINANCE (Room BH (S) 2.02)
 CO344 CAUSAL INFERENCE IN SUSTAINABLE INVESTING (Room BH (S) 2.03)
 CO384 LATENT VARIABLE MODELLING (Room BH (S) 2.05)
 CO248 RECENT ADVANCES IN SAMPLE SELECTION MODELS (Room BH (SE) 2.01)
 CO144 EMPIRICAL ANALYSIS OF CLIMATE CHANGE (Room BH (SE) 2.05)
 CO039 TWEETS, INFLATION AND MACROECONOMIC POLICIES (Room BH (SE) 2.09)
 CO359 TOPICS IN PANEL DATA MODELS AND THEIR APPLICATIONS (Room BH (SE) 2.12)
 CC491 TEXT DATA AND RELATED TOPICS (Room S-1.01)
 CC450 CONTRIBUTIONS IN CAUSAL INFERENCE (Room S-1.04)
 CC485 NETWORKS AND GRAPHICAL MODELS (Room K0.16)
 CC494 ANALYSIS OF CATEGORICAL DATA (Room S0.03)
 CC455 FORECASTING I (Room BH (SE) 1.05)
 CC500 MACHINE LEARNING IN ECONOMICS AND FINANCE II (Room BH (SE) 2.10)

Parallel Session P – CFECMStatistics2024

Monday 16.12.2024

14:40 - 16:20

CO272 SEMI-PARAMETRIC INFERENCE VIA DATA INTEGRATION (VIRTUAL) (Room S-2.25)
 CO214 STATISTICAL MODELLING OF TEXT DATA (Room S-1.01)
 CO003 MACHINE LEARNING AND OPTIMIZATION WITH APPLICATIONS (Room S-1.06)
 CO160 ON KERNEL ESTIMATION ON MANIFOLDS, TESTING OUTLIERS AND MINIMAX RISK (Room S-1.27)
 CO146 EcoSta JOURNAL (Room Auditorium)
 CO399 RECENT ADVANCEMENTS IN STATISTICAL NETWORK ANALYSIS AND BEYOND (Room K0.16)
 CO169 DEVELOPMENTS IN SPATIO-TEMPORAL MODELING OF HEALTH OUTCOME DATA (Room K0.18)
 CO082 CAUSAL INFERENCE (Room K0.19)
 CO313 STATISTICAL INFERENCE AND ESTIMATION UNDER DEPENDENCE (Room K0.20)
 CO299 ADVANCES IN SUBSAMPLING AND ORDER-OF-ADDITION EXPERIMENTS (VIRTUAL) (Room K0.50)
 CO031 FLEXIBLE LEARNING IN COMPLEX DATA ENVIRONMENTS (Room K2.31 (Nash Lec. Theatre))
 CO223 RECENT DEVELOPMENTS IN NON-EUCLIDEAN STATISTICS (Room K2.40)
 CO377 EVIDENCE INTEGRATION AND TRIANGULATION FOR GLOBAL HEALTH RESEARCH (Room K2.41)
 CO241 TOPICS IN MULTIVARIATE AND HIGH-DIMENSIONAL DATA (Room S0.03)
 CO155 STATISTICAL METHODS FOR BRAIN IMAGING DATA (Room S0.11)
 CO333 METHODS AND MODELS FOR ENVIRONMENTAL AND ECOLOGICAL DATA II (Room S0.12)
 CO289 PERSONALIZED MEDICINE AND REINFORCEMENT LEARNING (VIRTUAL) (Room S0.13)
 CO094 FUNCTIONAL AND DISTRIBUTIONAL DATA ANALYSIS (Room Safra Lec. Theatre)
 CO362 ANALYSIS OF NON-STATIONARY TIME SERIES (Room BH (S) 1.01 Lec. Theatre 1)
 CO238 ADVANCES IN BAYESIAN VARIABLE SELECTION AND COMPUTING (Room BH (SE) 1.01)
 CO338 BAYESIAN METHODS FOR DATA WITH LATENT STRUCTURE (Room BH (SE) 1.02)
 CO048 MACHINE LEARNING FOR FINANCIAL DATA (Room BH (SE) 1.05)
 CO329 RECENT DEVELOPMENTS IN BAYESIAN METHODS (Room BH (SE) 1.06)
 CO078 ESG AND FINANCIAL-ECONOMIC SUSTAINABILITY (Room BH (S) 2.01)
 CO073 NEW FRONTIERS IN ARTIFICIAL INTELLIGENCE APPLICATIONS (Room BH (S) 2.02)
 CO216 SUBJECTIVE BELIEFS, SURVEYS, AND OPTIONS DATA (Room BH (S) 2.05)
 CO190 ADVANCES ON BAYESIAN BIostatISTICS AND BIOINFORMATICS (VIRTUAL) (Room BH (SE) 2.01)
 CO163 NONPARAMETRIC, SEMIPARAMETRIC, AND FUNCTIONAL DATA ANALYSIS (Room BH (SE) 2.10)
 CO258 MEASUREMENT ERROR AND MISSING DATA IN STUDIES OF TIME AND SPACE (Room BH (SE) 2.12)
 CC466 STOCHASTIC PROCESSES (Room S-1.04)
 CC420 FINANCIAL ECONOMETRICS II (Room BH (S) 2.03)
 CC447 APPLIED ECONOMETRICS (Room BH (SE) 2.05)
 CC498 FORECASTING II (Room BH (SE) 2.09)

Parallel Session Q – CFECMStatistics2024

Monday 16.12.2024

16:50 - 18:30

CO147 DESIGN AND ANALYSIS OF STUDIES IN KIDNEY DISEASE (VIRTUAL) (Room S-2.25)
 CO388 NEW INVESTIGATORS IN COMPUTATIONAL STATISTICS (VIRTUAL) (Room S-1.04)
 CO400 GEOMETRIC DATA ANALYSIS FOR COMPLEX DATA STRUCTURES (Room S-1.06)
 CO021 RECENT ADVANCES OF MACHINE LEARNING IN INTERDISCIPLINARY PROBLEMS (Room S-1.27)

CO100 MACHINE LEARNING IN ASSET PRICING (Room Auditorium)
CO037 STATISTICAL ANALYSIS OF NETWORK AND OTHER COMPLEX DATA (Room K0.16)
CO019 METHODOLOGY AND PRACTICE FOR DATA ORIGINATING FROM RANDOMIZED TRIALS (Room K0.18)
CO166 STATISTICAL INNOVATIONS IN CLINICAL TRIAL DESIGN AND ANALYSIS (Room K0.19)
CO242 STATISTICAL INFERENCE WITH GRAPHS (Room K0.20)
CO269 RECENT INNOVATIONS IN TWO-PHASE STUDY DESIGN AND ANALYSIS (Room K0.50)
CO143 NEW ADVANCES IN CAUSAL INFERENCE (Room K2.31 (Nash Lec. Theatre))
CO277 SPATIAL DATA SCIENCE (Room K2.40)
CO402 ROC CURVES/EVALUATION OF BIOMARKERS (Room K2.41)
CO164 HANDLING COMPLEX DATA AND COMPLEXITY (Room S0.03)
CO067 NOVEL STATISTICAL METHODS AND ANALYSES FOR NEUROIMAGING AND BIOMEDICAL DATA (Room S0.11)
CO265 METHODS FOR MULTIPARAMETER EVIDENCE SYNTHESIS AND SPATIAL OMICS DATA (Room S0.12)
CO029 RECENT ADVANCES IN COMPLEX ANALYSIS OF GENOMICS DATA (Room S0.13)
CO034 STATISTICAL LEARNING WITH COMPLEX FUNCTIONAL DATA (Room Safra Lec. Theatre)
CO252 MODERN CHANGE-POINT ANALYSIS (Room BH (S) 1.01 Lec. Theatre 1)
CO120 BAYESIAN STATISTICAL LEARNING IN PRACTICE (Room BH (SE) 1.01)
CO181 ADVANCES IN BAYESIAN SMOOTHING AND RECURSIVE PARTITIONING (Room BH (SE) 1.02)
CO186 DISTRIBUTION-LEAN STATISTICAL INFERENCE (Room BH (SE) 1.06)
CO407 CLIMATE RISK UNCERTAINTY (Room BH (S) 2.02)
CO177 UNCERTAINTY AND INFORMATION FLOW IN FORECASTING AND FINANCIAL MARKETS (Room BH (S) 2.03)
CO199 FLEXIBLE ESTIMATIONS (Room BH (S) 2.05)
CO092 STATISTICAL INFERENCE, MODELING, AND OPTIMAL DESIGN (Room BH (SE) 2.05)
CO020 INDIVIDUAL HETEROGENEITY FOR MACROECONOMIC FLUCTUATIONS (Room BH (SE) 2.09)
CO354 SPATIAL STATISTICS AND ITS APPLICATIONS (Room BH (SE) 2.10)
CO309 STATISTICAL METHODS FOR ANALYZING HIGH-DIMENSIONAL CANCER DATASETS (Room BH (SE) 2.12)
CC479 SOFTWARE (Room S-1.01)
CC483 EMPIRICAL FINANCE (Room BH (SE) 1.05)
CC430 TIME SERIES ECONOMETRICS (Room BH (S) 2.01)
CC495 DATA ANALYSIS AND EMPIRICAL STUDIES (Room BH (SE) 2.01)